

HEARTSTART FR2-SERIES DEFIBRILLATORS



Supplies and Accessories

Philips offers a full range of services, supplies and accessories – from carrying cases and storage options to defibrillator pads and ECG monitoring leadsets – to optimize the performance of its FR2-series defibrillators and support your efforts in treating cardiac arrest victims. These products are designed and manufactured to the highest levels of quality, with ease-of-use, reliability and durability in mind.



M3868A
FR2-SERIES
CARRYING CASE



YC
FR2-SERIES
WATERPROOF
CARRYING CASE

FR2 CARRYING CASES

Semi-rigid

A red cordura, semi-rigid carrying case (M3868A) is available to hold the device as well as its main accessories and supplies.

Vinyl

An "easy-to-clean" vinyl carrying case (M3869A) is also available. Both the cordura and vinyl carrying cases are intended for use in environments where the defibrillator is protected from moisture and harsh treatment.

Hard-shell

Our waterproof carrying case made of hard-shell plastic (Philips product code YC) is suited for more rigorous use, particularly in wet outdoor settings. It can also accommodate the contents of the Fast Response Kit.

zippered pouch which can be attached to the handle of the semi-rigid or vinyl carrying cases.

WALL MOUNTING SOLUTIONS

The Philips Wall Mount Bracket and Defibrillator Cabinet let you strategically place defibrillators for fast access and response.

Wall Mount Bracket

The Wall Mount Bracket (M3857A) is designed specifically for holding a Philips defibrillator and its accessories. The defibrillator's carrying case can be tethered to the Wall Mount bracket with a breakaway Secure-Pull Seal (M3859A), to discourage tampering. A broken seal indicates that the defibrillator has been used or removed from the Wall Mount and accessories may need to be replenished.



68-PCHAT
FAST RESPONSE
KIT

FAST RESPONSE KIT

The Fast Response Kit (68-PCHAT) contains tools and supplies typically needed for patient care and personal protection: 2 pairs of hypoallergenic nitrile gloves, a Laerdal pocket breathing mask, paramedic scissors, a Gallant chest hair razor, and a large extra-absorbent paper towel. These items are contained in a 5-1/2" x 9-1/2"



M3857A
WALL MOUNT BRACKET



M3859A
SECURE-PULL
SEAL

Defibrillator Cabinets

The defibrillator Cabinet, constructed of heavy gauge steel and tempered glass, protects your defibrillator from theft and the elements. Equipped with an audible alarm and flashing lights (powered by two 9-volt alkaline batteries), the Cabinet attracts attention to mobilize assistance during a cardiac emergency or deter theft. Opening the Cabinet's door activates the audible alarm and lights. For locations where a siren is inappropriate, the audible alarm can be disabled.

In buildings with a central security system, your facilities people or alarm company can connect the cabinet alarm to your system for a more coordinated response to a cardiac emergency. The alarm can also be connected to a programmable auto-dialer.

The Cabinet is available in two styles: a wall surface mounted Cabinet, for easy installation without cutting into walls, and a semi-recessed model, that is inserted into a wall cut-out, for a less obtrusive look. The semi-recessed model is appropriate where Americans with Disabilities Act (ADA) regulations are a consideration.*

AED Wall Sign

An AED Wall Sign (M3858A) hanging above a Wall Mount Bracket or Cabinet gives even greater visibility to the defibrillator.

POWER SUPPLIES

FR2-Series Standard Battery

FR2-series defibrillators come with a disposable lithium manganese dioxide battery (M3863A), which has a typical standby life of 5 years.**

FR2+ Rechargeable Battery

In hospital and EMS environments, where the useful life of a defibrillator's disposable battery can be consumed in a relatively short period of time, the FR2+ Rechargeable Battery (M3848A) provides a cost-effective option for frequent-use applications, such as back-to-back sudden cardiac arrest responses and monitoring patients during transport.

This Lithium-Ion battery is fully charged (using the Charger M3849A) in just 3 hours to provide 100 shocks (typical) or 5 hours (typical) of ECG display time. The "fuel gauge" on the FR2+ displays the battery's remaining power. Under normal conditions, the FR2+ Rechargeable Battery withstands 300 charge-discharge cycles or 2.5 years of use.



M3858A

AED WALL SIGN

Dimensions:

7" (18 cm) w X 10" (25.5 cm) h



M3863A

FR2-SERIES LITHIUM MANGANESE DIOXIDE BATTERY



M3848A AND M3849A

FR2+ RECHARGEABLE BATTERY AND CHARGER



PFE7024D

SURFACE MOUNTED CABINET

Dimensions:

16" (41 cm) w X 22.5" (57 cm) h
X 6" (15 cm) d

PFE7023D

SEMI-RECESSED CABINET

Dimensions:

Recessed Compartment -
14" (36 cm) w X 22" (56 cm) h
X 6" (15 cm) d

Footprint on wall -
16.5" (42 cm) w X 24.5"
(62 cm) h X 2.5" (6 cm) d



* The Americans with Disabilities Act requires that objects not protrude more than 4 inches into foot traffic areas of open aisles and walkways unless the object's bottom edge is no higher than 27 inches from the ground.

** Use of the defibrillator, additional battery insertion tests, or exposure to temperature extremes may shorten the battery life.

PADS AND ADAPTERS

HeartStart FR2 Infant/Child Reduced-Energy Defibrillator Pads

Philips HeartStart FR2 Infant/Child Reduced-Energy Defibrillator Pads (M3870A) enable minimally trained responders to safely and promptly defibrillate infants and children under 8 years of age or 55 pounds with an FR2-series defibrillator.

These special infant/child pads contain electronics that attenuate, or reduce, the energy of the defibrillator's shock from 150 to 50 Joules, an appropriate dosage of SMART Biphasic therapy for infants and small children.¹ And the FR2-series defibrillator can evaluate children's heart rhythms with outstanding accuracy for appropriate shock/no-shock decisions.²

The pads' design was carefully thought out to ensure that, even for the most inexperienced user under the most stressful circumstances, it is instantly obvious that these pads are for children and infants only. This helps ensure that the correct pads are chosen when you need to be prepared to treat both adults and children. The packaging, graphics, and pink teddy bear-shaped connector clearly communicate pediatric use.

To learn, practice or demonstrate defibrillation of infants and children, Philips offers reusable Infant/Child Training Pads (M3871A) for its FR2-series defibrillators. These pads feature a yellow teddy bear leadwire connector and a red warning label to distinguish them from the actual Infant/Child Reduced-Energy Defibrillator Pads.

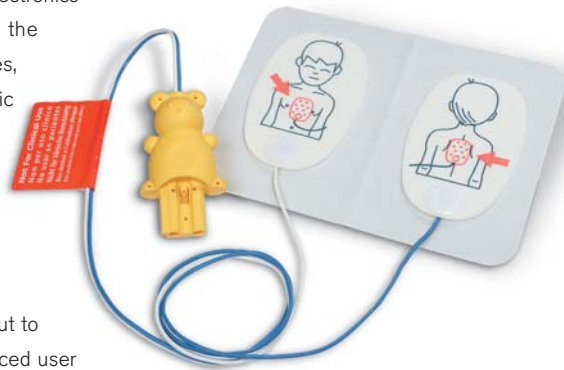

**M3871A
FR2 INFANT/CHILD TRAINING PADS**

HeartStart Adult AED Defibrillator Pads

HeartStart Adult AED Defibrillator Pads (DP2 and DP6), recommended for patients 8-years and older, or above 55 pounds (25kg), are optimized for AED use with Philips FR2-series defibrillators. Constructed of a thin flexible conductor sandwiched between a protective polymer backing and a hydro-gel adhesive, these pads withstand the rigors of CPR and harsh conditions. Soft, flexible and oval-shaped, HeartStart Adult AED Pads conform to body contours for ample surface contact and adhesion. The robust lead wire connector is ergonomically designed, enabling fast and easy insertion.

For smooth handoff to advanced life support (ALS) personnel, the pads connector is compatible with the hands-free cable of HeartStart manual defibrillators which have advanced capabilities. Once attached, these multifunction electrode pads can provide ECG monitoring, external pacing, and synchronized cardioversion, in addition to defibrillation.

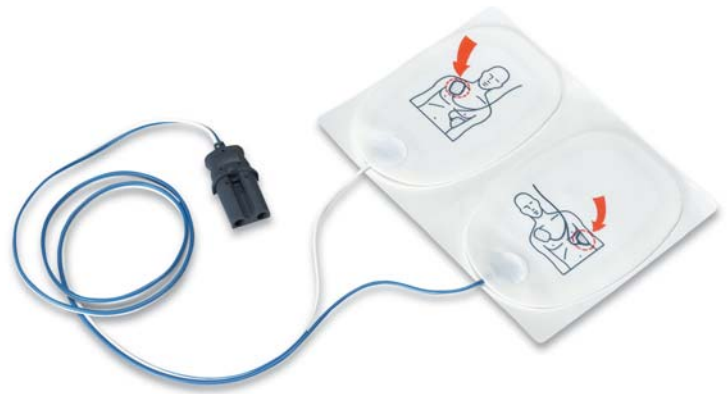

**DP2/DP6
ADULT AED DEFIBRILLATOR PADS**

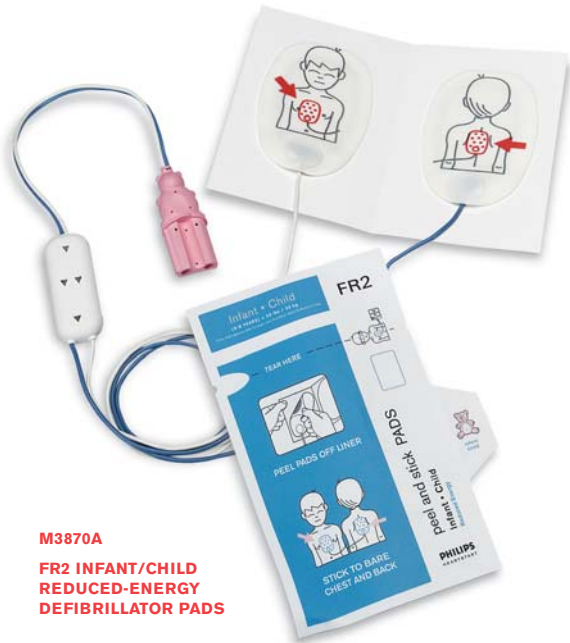

**M3870A
FR2 INFANT/CHILD
REDUCED-ENERGY
DEFIBRILLATOR PADS**

1. Tang, et al. Fixed-energy Biphasic Waveform Defibrillation in a Pediatric Model of Cardiac Arrest and Resuscitation *Crit Care Med* 2002; 30:2736-2741, December 2002.
2. Cecchin, et al. Is Arrhythmia Detection by Automatic External Defibrillator Accurate for Children? Sensitivity and Specificity of an AED Algorithm in 696 Pediatric Arrhythmias. *Circulation* 2001; 103:2483-2488, May 22, 2001.

HeartStart Adapters

HeartStart Adult AED Defibrillator Pads may also be used with defibrillators from other manufacturers, using Philips HeartStart Adapters, whether defibrillators are biphasic or monophasic, manual or automated. The adapters allow ALS caregivers to connect the pads to their manual defibrillator. Adapters cannot be used with FR2 Infant/Child Reduced-Energy Defibrillator Pads.

ADAPTER MODEL 05-10200

Fits Philips hands-free cables M3507A or M1750A/B for connection to Hewlett-Packard CodeMaster 100, XE, XL, and XL+; Philips Heartstream/HeartStart XL and XLT; and Laerdal Heartstart 4000 defibrillator/monitors

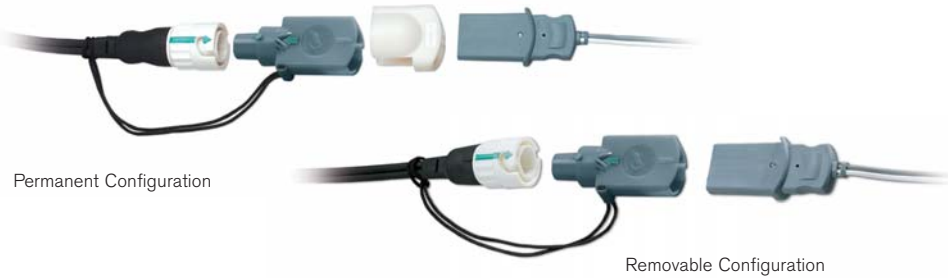

ADAPTER MODEL 05-10000

Removable adapter for Medtronic Physio-Control Quik-Combo LifePak 9, 10C, 11, 12, and 500 defibrillators



ADAPTER MODEL 05-10100

Removable adapter for Zoll 1200, 1400, 1600 and M-Series defibrillators



DATA CARD AND TRAY

The data card (M3854A) holds approximately 8 hours of incident and ECG information, or one hour with voice recording. A flash data card reader enables data transfer from the card to a personal computer for use with Philips HeartStart Event Review data management software.



**M3854A
DATA CARD AND TRAY**

FR2+ ECG Assessment Module

Ideal where manual defibrillators and monitors are impractical, the Philips FR2+ ECG Assessment Module enables the professional responder to use the HeartStart FR2+ Defibrillator to assess the heart rhythms of conscious and/or breathing patients who may be in cardiac distress. With this reusable unit, caregivers knowledgeable in reading ECG rhythms can use the defibrillator's display to view the Lead II ECG rhythm of a patient who may be experiencing dizziness, chest discomfort, or becomes unconscious but is still breathing.**

If arrhythmias are observed or the patient's status changes, the responder can proactively determine next steps. And if the patient goes into cardiac arrest during monitoring, the responder can react immediately by switching to defibrillation pads, potentially reducing the time to deliver defibrillation therapy and improving the outcome.

The FR2+ ECG Assessment Module, compatible with most standard snap monitoring electrodes, including M2202A, is available in two configurations:

M3873A

AAMI color convention with red, white and black leadwire connections.

M3874A

IEC color convention with green, red and yellow leadwire connections.



**M3873A
PHILIPS FR2+ ECG
ASSESSMENT
MODULE
(AAMI)**

**M3874A
PHILIPS FR2+ ECG
ASSESSMENT
MODULE
(IEC)**

**M2202A
RADIOLUSCENT FOAM
MONITORING ELECTRODES
(SHOWN WITH BUTTON SNAP LEAD)**

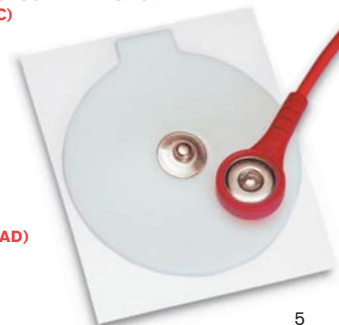

** FR2+ ECG screen is not suitable for diagnostic and ST-segment interpretation.



M3752A
PHILIPS HEARTSTART AED TRAINER 2



M3753A
REMOTE CONTROL



M3864A WITH M3855A
TRAINING AND ADMINISTRATION PACK WITH CHARGER



M3754A
PROGRAMMING KIT

PHILIPS TRAINING SOLUTIONS
Training and Administration Pack

When equipped with the rechargeable training and administration pack (M3864A), the FR2-series defibrillator acts as a trainer. Its shock delivery capability is disabled while you train with nine realistic scenarios. And when connected to a simulator or a special training manikin capable of producing an ECG rhythm, the FR2+ with training and administration pack will produce realistic responses to various heart rhythms.

In addition to training, the pack allows you to reconfigure the defibrillator's behavior to your specific cardiac arrest protocol.

AED Trainer 2

For training many responders simultaneously, Philips HeartStart AED Trainer 2 (M3752A) is a more flexible and economical solution. AED Trainer 2 helps your responders learn to use FR2-series defibrillators in simulated sudden cardiac arrest episodes for an extremely realistic

training experience. AED Trainer 2 looks and behaves like the FR2-series defibrillators, but cannot deliver an actual defibrillation shock.

It is pre-configured with 10 realistic training scenarios, developed in accordance with internationally recognized emergency responder training programs. Voice prompts in various languages and additional custom scenarios can be configured using the optional programming kit (M3754A).

An optional remote control (M3753A) lets the instructor adjust the Trainer's volume, select a scenario, pause and then resume the scenario in progress to give instruction, and override the scenario to test how students respond to a variety of situations they may encounter.

The AED Trainer 2 comes equipped with one set of adult-size reusable training pads (07-10900), a quick reference instruction card, a user guide, and a carrying case.

Also available is the all-in-one AED Little Anne Training System (M3756A), for added realism. In addition to the AED Trainer 2, quick reference card, user guide, and carrying case, this total training solution also includes the remote control, special training pads (M3755A) and a Laerdal AED Little Anne training manikin. The Trainer, AED Little Anne manikin, and special training pads work together to provide feedback on the quality of pads placement.

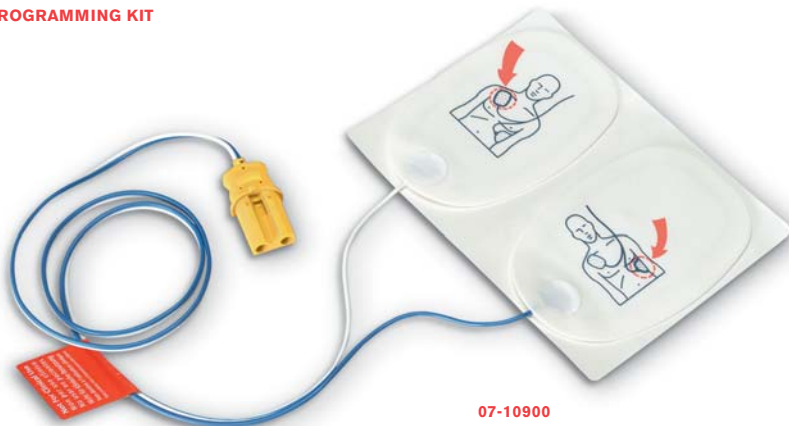

07-10900
HEARTSTART TRAINING PADS



M3756A
AED LITTLE ANNE TRAINING SYSTEM

Instructor's Training Toolkit

The training toolkit (M5066-89100) includes instructional aids, such as a videotape and CD with a PowerPoint presentation, for teaching groups of people to operate the HeartStart FR2-series defibrillators and the HeartStart OnSite Defibrillator.



M5066-89100
INSTRUCTOR'S TRAINING TOOLKIT

ACCESSORIES AVAILABLE FROM PHILIPS' PARTNERS

Magnavox Mobile911

A Magnavox Mobile911 emergency cellular phone in a defibrillator Wall Cabinet or a Fast Response Kit improves the responder's ability to summon public safety personnel to the scene of a cardiac emergency.

It can be used two ways. With the touch of a button, Mobile911 lets the caller speak to a local 911 operator. It works anywhere in the U.S. where analog cellular phones operate. Mobile911 is also equipped with a 95-dB siren, for attracting attention and assistance.

It never needs recharging; just replace alkaline AAA batteries once a year. And, there's no contract or service fee. The purchase price is all you pay.

Magnavox Mobile911 is from First Alert and can be purchased on the Web at <http://www.mobile911.com>.

AED Jump Bag

This slim-profile bag from K M Products is ideal for carrying emergency equipment and supplies in addition to the FR2-series defibrillator. Its triple-layer construction of ballistic nylon, foam padding and nylon packcloth is designed to withstand years of hard use and will accommodate:

- FR2-series defibrillator
- M9 oxygen cylinder, regulator and mask
- V-Vac suction unit
- Fast Response Kit
- First-aid supplies
- Spare battery and pads

And it has several customizable compartments to hold additional items. The bag measures 19 x 15 x 5.75 inches. All supplies are held securely in designated areas by grommets or straps. The bag features "one zipper access" to contents and a view window for the status indicator light on the FR2-series defibrillator.

For more details or to order, contact K M Products at kmproductsinc@qwest.net.



AED JUMP BAG



MAGNAVOX MOBILE911

IMPLEMENTATION AND FINANCING SERVICES
Financing programs

Philips has financing programs that make it easy to acquire equipment and services, no matter what your budget situation. You have options when capital budgets are tight or you'd rather use those funds for other purposes.

The Philips Deferred Payment Program lets you put off paying for your equipment for up to 12 months, interest free. The Philips Installment Plan lets you pay for your equipment in easy monthly payments. And the Philips Lease Plan offers tremendous flexibility, easy payments, and protection against obsolescence. You can choose between an operating lease, where you return the equipment at the end of the term, or a capital lease, where you'll own the equipment at the end of the term. You can also include related non-Philips products in the lease, to further simplify the buying process.

Site Assessment

Philips offers consulting services to guide you in deploying defibrillators and other resources at your site. A Philips representative or clinical implementation manager will conduct a site assessment to advise you on best practices to optimize your defibrillation program.

MD Solutions Medical Direction

MD Solutions Medical Direction (MDN1000) gives your defibrillator program the medical oversight needed for a sound response to sudden cardiac arrest (SCA). Medical direction includes these services: authorization to purchase and use defibrillators, written standing orders for response to SCA, approval of your training program, a review of any changes to your response protocol and maintenance program, a written review of any SCA events, and telephone consultations. All are provided by a licensed physician who is an expert in cardiac care in the workplace.

Extended Warranty

The HeartStart Extended Warranty – available for ForeRunner, FR2-series, and OnSite defibrillators – helps protect your investment, by adding 2 additional years to the standard 5-year warranty, giving you 7 years of coverage.

PHILIPS MEDICAL SYSTEMS IS PART OF ROYAL PHILIPS ELECTRONICS

On the web: www.medical.philips.com

Via e-mail: medical@philips.com

By fax: +31 40 27 64 887

By postal service:

Philips Medical Systems
 Global Information Center
 I.B.R.S. / C.C.R.I. Numéro 11088
 5600 VC Eindhoven
 Pays-Bas / The Netherlands

CORPORATE HEADQUARTERS

Philips Medical Systems
 Nederland B.V.
 Postbus 10.000
 5680 DA Best
 Netherlands

UNITED STATES

Andover, Massachusetts
 (800) 934-7372

CANADA

Markham, Ontario
 (800) 291-6743

EUROPE, MIDDLE EAST AND AFRICA

Böblingen, Germany
 Fax: (49) 7031 463 1552

LATIN AMERICA HEADQUARTERS

Sunrise, Florida
 (954) 835-2600

ASIA PACIFIC HEADQUARTERS

Wanchai, Hong Kong
 (852) 2821 5888

© Philips Medical Systems
 North America Corporation, 2003
 All rights are reserved. Reproduction in whole or in part is prohibited without the prior written consent of the copyright holder.

Philips Medical Systems North America Corporation reserves the right to make changes in specifications or to discontinue any product at any time without notice or obligation and will not be liable for any consequences resulting from the use of this publication.

Printed in U.S. January 2003
 Part #5990-0755EN

NOTE: HeartStart FR2-series supplies and accessories are covered by your defibrillator prescription.